

# SCHEDULE "A"

PORTSMOUTH ROAD

## CITY OF NANAIMO PRELIMINARY LAYOUT ACCEPTANCE

2019-OCT-01  
Date

2020-OCT-01  
Expiry Date

Approved By

*[Signature]*

PROPOSED LOT A  
EXISTING APARTMENT UNITS  
96 UNITS TOTAL  
60 TWO BED 36 ONE BED  
PARKING BYLAW REQUIREMENTS  
60 \* 1.26 = 76 36 \* 0.89 = 32 TOTAL 108

EXISTING PARKING STALLS (AS PAVED)  
PROPOSED LOT A 108  
PROPOSED LOT B 31

**RECEIVED**  
SUBD 0135 /  
APR 02 2019

STRATA PLAN VIS3536

APPLECROSS ROAD

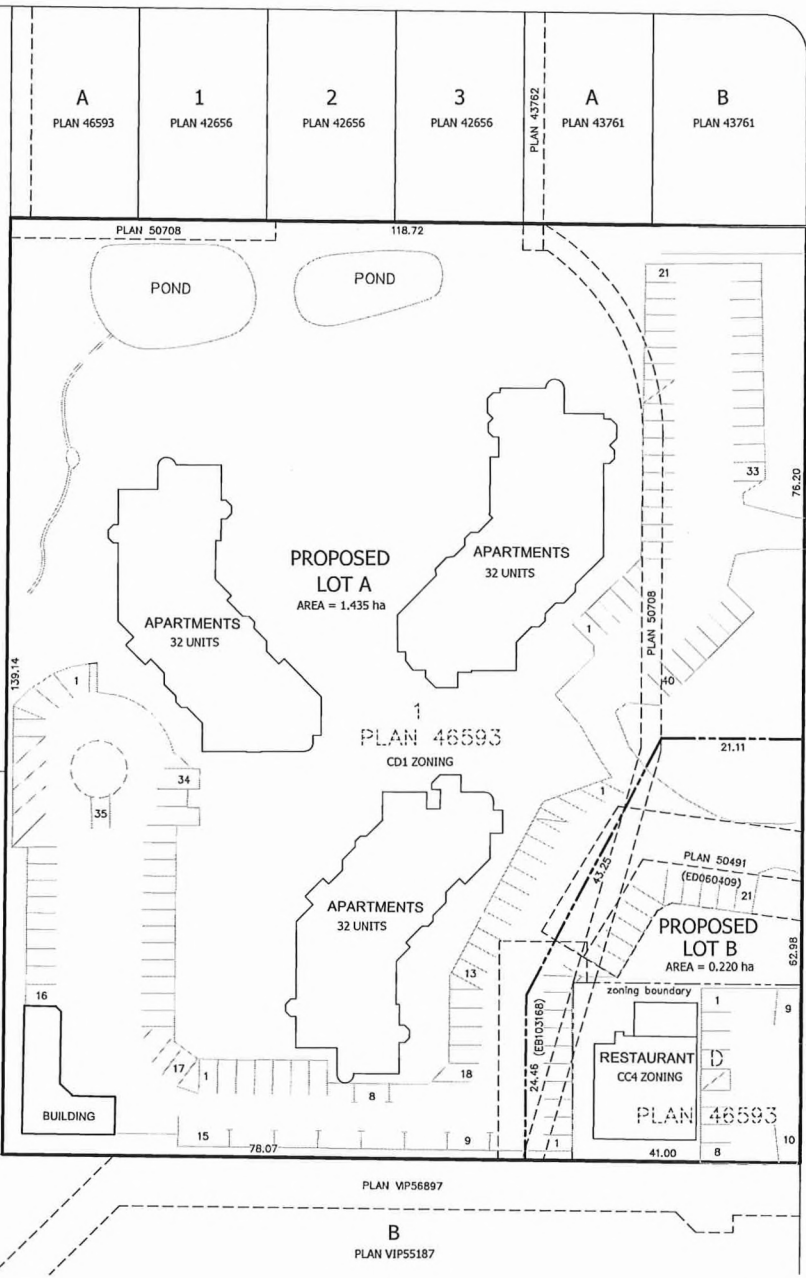

NOTES:  
DISTANCES AND ELEVATIONS ARE IN METRES. ELEVATIONS ARE DERIVED FROM INTEGRATED SURVEY CONTROL MONUMENTS.  
THIS PLAN PURPORTS TO POSITION ONLY THE ACTUAL LAND AND OR PROPOSED IMPROVEMENT(S) SHOWN RELATIVE TO ONLY THE BOUNDARIES SHOWN OF OR APPURTENANT TO THE SUBJECT PARCEL(S).  
THIS PLAN PROVIDES NO WARRANTY OR REPRESENTATION WHATSOEVER WITH RESPECT TO THE LOCATION OF ANY OTHER ACTUAL OR PROPOSED IMPROVEMENT(S) RELATIVE TO ANY BOUNDARY OF OR APPURTENANT TO THE SUBJECT PARCEL(S).  
AERIAL IMAGE IS CITY OF NANAIMO 2009 ORTHOPHOTOGRAPHY. CONTOURS ARE DERIVED FROM 2009 CITY OF NANAIMO LIDAR SURVEY.  
FIELD SURVEY COMPLETED SEPTEMBER 27, 2018.  
LOT ALIGNMENT IS PRELIMINARY AND DERIVED FROM REGISTERED PLANS.  
THIS PARCEL MAY BE SUBJECT TO REGISTERED CHARGES & PERMITS:  
- COVENANT EW31639;  
- EASEMENTS EB103168, ED60409;  
- STATUTORY RIGHT OF WAYS R42384, EB30030;  
THIS PLAN DOES NOT PURPORT TO VERIFY COMPLIANCE WITH THE RESTRICTIONS THEREIN.

NO.	DATE	REVISION
00	DEC. 14, 2018	FIRST ISSUE.
01	DEC. 17, 2018	REVISE BOUNDARY TO DRIVE AISLES
02	JAN. 17, 2019	REVISE BOUNDARY - UPDATE ADD BUILDINGS AND PARKING
03	APRIL 1, 2019	ADD PARKING INFORMATION

PROJECT: 6595 AND 6597  
APPLECROSS ROAD

CLIENT: NPR GP, INC. INC.NO. A0082281

DRAWING: PRELIMINARY LOT LAYOUT

DATE: DEC.14/18

SCALE: 1:500

DRAWN: TP

FILE: 18102-3 PLA  
BP: 18102

SHEET: 1 OF 1

**WILLIAMSON & ASSOCIATES**  
PROFESSIONAL SURVEYORS  
3088 BARONS ROAD NANAIMO B.C. V9T 4B5  
PHONE: (250) 756-7723 FACSIMILE (250) 756-7724  
EMAIL: WAPS@TELUS.NET